

自定心全自动虎钳 / SELF-CENTERING AUTOMATIC VISE

GRIP MATIC

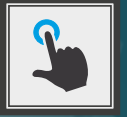

AUTOMATIC CONTROL



5 AXIS MACHINE



AIR OR OIL DIRECT INPUT



5 轴加工中心的理想选择

IDEAL FOR 5 AXIS MACHINING CENTRES



液压驱动和气动两种形式 PNEUMATIC DOUBLE EFFECT OR HYDRAULIC

作为多功能虎钳系列的一种，ART.670全自动咬合式虎钳系列用于五轴加工中心，致力于五面加工，并始终遵循高精度、高刚性的产品原则。动力源可以是液压油或者压缩空气，通过双作用活塞实现对虎钳整体动作的控制。其中模块化也是很重要的一个特点，这个特点使得此系列虎钳适用于任何类型的机床，同时由于其自身结构和可由数控机床完全自主控制的特性，在加工中可实现自动化夹紧过程，提高公司生产力。

As all the other vises of the Multitasking Series, GripMatic series Art.670 is conceived for 5-axis machining centers in order to work on 5 surfaces always respecting the tight tolerances and the high rigidity. The activation is made by the oil or compressed air through a double effect piston that grants the complete managing of the vise. One of the main features is modularity that allows this kind of vise to be used on any type of machine and, thanks to its configuration and complete handling by CNC, it is also possible to automate the clamping process so increasing the productivity of your company.

装配软动钳口的自定心虎钳 适用于五轴加工中心

虎钳 (型号) 参数 / Vise (type) size		2	3	4	
		PN 7 / ID 19	PN 14,4 / ID 37,5	PN 16,9 / ID 47	
Art. 670	Corsa / Stroke →	A	6,4	8,5	12
	自定心液压/气动虎钳 · 装配 软动钳口	A1	88,9	130,2	162
	Self-centering pneumatic or hydraulic vise with soft movable jaws	B	25	30	35
		C	80	105	130
		D	108	166	206
		E	52	78	95
		G	10	12	16
		H	90	140	170
		W	74	99	124
		kg	6,7	20	38
	Cod	7.67.0PN20	7.67.0PN30	7.67.0PN40	
	Cod	7.67.0ID20	7.67.0ID30	7.67.0ID40	

Corsa / Stroke →
自定心液压/气动虎钳 · 装配 软动钳口

Self-centering pneumatic or hydraulic vise with soft movable jaws

- Art. 83
- Art. 670P
- Art. 670IDL
- Art. PN16
- Art. PN04
- Niplon

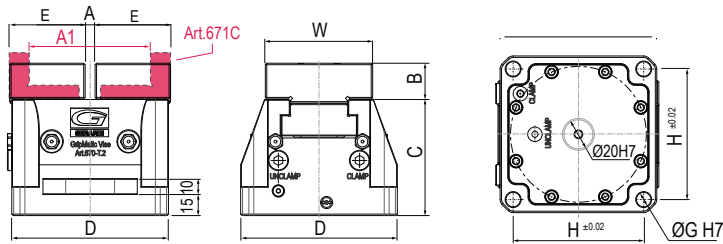

得益于内部安装的模具弹簧，Art.670咬合式气动虎钳可以获得更好的夹紧参数，以实现正常功能。该系统可确保更高的安全性，即使在压力损失的情况下也能夹紧工件，从而避免夹具损坏和工人受伤。

Thanks to the internal mold springs, Art.670 GripMatic pneumatic vise allows to obtain better clamping parameters, in respect to the normal functioning. This system guarantees a higher safety level as it clamps the workpiece even in case of pressure loss and so avoiding fixtures damages and workers injuries

气动咬合式虎钳 PNEUMATIC VISE



Art.670PN

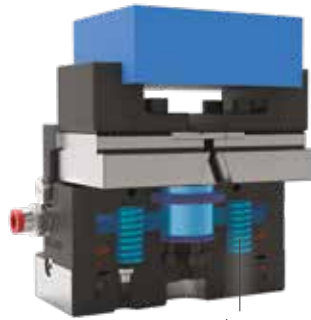
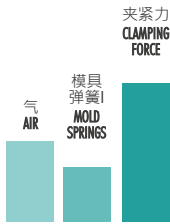

液压咬合式虎钳 HYDRAULIC VISE



Art.670ID

DISPONIBILI ANCHE
60 o 350 BAR
ALSO AVAILABLE
60 or 350 BAR



气动咬合式虎	型号 2	型号 3	型号 4
Air Pressure Input (bar)	Clamping Force (kN)	Clamping Force (kN)	Clamping Force (kN)
7	5,6	10,7	11,4
8	6,1	12,3	13,3
9	6,6	13,2	14,6
10	7	14,4	16,9

液压咬合式虎	型号 2	型号 3	型号 4
Oil Pressure Input (bar)	Clamping Force (kN)	Clamping Force (kN)	Clamping Force (kN)
10	5,8	15	-
15	8,5	21	27
20	11,7	27	38
25	14,5	33,5	47
30	17	37,5	-

要增加气压，请使用Art.408增压器
To increase the air pressure use the multiplier Art.408

因润滑、在机床工作台上夹紧、摩擦等因素会导致上述值在±10%的范围内发生改变
Some factor as lubrication, clamping on the machine table, frictions and more can modify above values within a ±10%
请勿超过图表值 - DO NOT EXCEED CHART VALUES

T.2 气动 - AIR 液压 - OIL

建议最大值 - Max suggested value

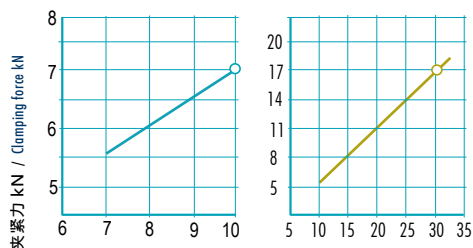

气/液出口压力 (bar) - Air or Oil outlet pressure (bar) 1 bar = 14,5 psi
最小开启压力 (bar) - Min. pressure opening jaw (bar) = 6 bar

T.3 气动 - AIR 液压 - OIL

建议最大值 - Max suggested value

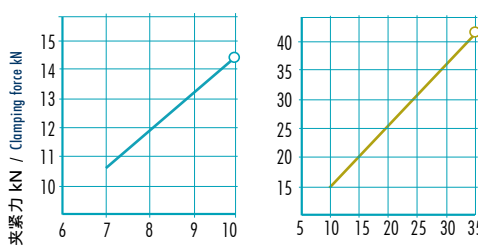

气/液出口压力 (bar) - Air or Oil outlet pressure (bar) 1 bar = 14,5 psi
最小开启压力 (bar) - Min. pressure opening jaw (bar) = 5 bar

T.4 气动 - AIR 液压 - OIL

建议最大值 - Max suggested value

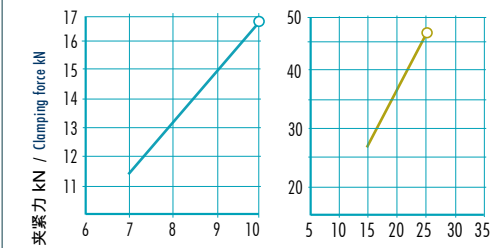

气/液出口压力 (bar) - Air or Oil outlet pressure (bar) 1 bar = 14,5 psi
最小开启压力 (bar) - Min. pressure opening jaw (bar) = 5 bar

用于紧凑型自动夹紧虎钳的转接板 INTERFACED PLATS FOR GRIPMATIC VISES

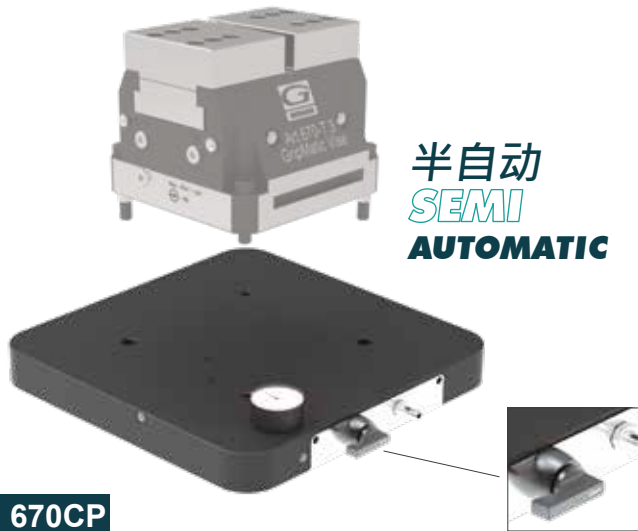

Art. 670CP

用于紧凑型自动夹紧虎钳Art.670PN的半自动转接板。通过手动控制开关实现快速通断气。

Interface plate for GripMatic vise Art.670PN - semi-automatic quick coupling air input and manual system control through a selector.

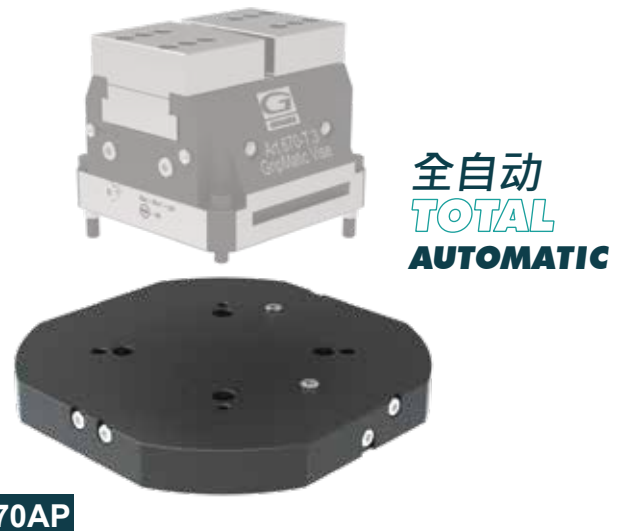

Art. 670AP

用于紧凑型自动夹紧虎钳Art.670PN的全自动转接板。由CNC直接控制。机床工作台对转接板实现通断气。此转接板可根据机器的特性（工件定位检查、清洁方式）实现完全定制。

Interface plate for GripMatic vise Art.670PN - automatic with air input through the machine table and possible to control directly by the CNC. This plate can be fully tailored according the characteristics of the machine (workpiece positioning check and cleanliness).

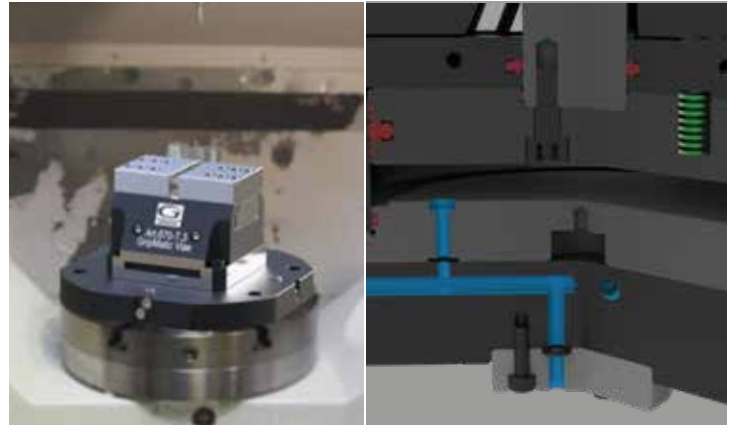

全自动咬合式虎钳系列专为5轴加工中心设计，在节省空间的基础上可实现五面精准加工，并且具有极高的耐磨性，减少偏差。

- √ 可以利用液压油或者压缩空气控制虎钳的松开/夹紧
- √ 油/气输入口设置在虎钳下方表面，这样可以直接通过机械主轴配合转接板结构进行油/气输入。
- √ 由于采用了抗摩擦处理和特殊的润滑剂，保证了内部轨道的高质量滑动，因此在气动应用中也能获得最大的性能。
- √ 可以使用检测器对自动化操作进行准确控制
- √ 备有多种形式的钳口：
- 可加工软钳口，可加工窄钳口，可安装光面、咬合齿、槽面等特定钳口的动钳口。
- √ 虎钳配有护板，可防止铁屑进入虎钳内部

Designed for 5 axis machines, GripMatic series of vises allow machining operations on the 5 workpieces sides with perfect alignment in a space saving design, extremely high wear resistance, with reduced deflection.
Air or oil input both lateral and lower.

- √ Possibility to manage the opening/closing by compressed air or oil
- √ Configuration of the lower surface to allow the addition of the compressed air or oil through an interface plate directly from the machine spindle
- √ High level of sliding of the internal rails ensured thanks to an anti-friction treatment and specific lubricants always for max performances also with pneumatic use.
- √ It is possible to apply a proximity detector for the correct handling of the automatisms.
- √ Soft workable jaws, narrow-width workable jaws, jaws configured for the use of specific jaw plates (smooth, grip, serrated...)
- √ The vise is equipped with covering carters that shelter the item from chips.

用于咬合式虎钳的定动钳口 JAWS & JAW PLATES FOR GRIPMATIC VISES

咬合式虎钳钳口 - GripMatic Jaws

Art. 671A

软动钳口
Soft machineable movable jaw

无硬度 - Not Hardened



Example 1

Art. 671B

窄动钳口(软)
Soft machineable narrow movable jaw

无硬度 - Not Hardened



Example 2

Art. 671C

台阶动钳口(软)装配标准平钳口
Soft machineable movable jaw for width standard jaw plates

无硬度 - Not Hardened



Example 3



Art. 243

槽面钳口
Grooved straight plate



Art. 245

光面钳口
Smooth straight jaw plate



Art. 247G

咬合式钳口
Straight plate with GRIP inserts

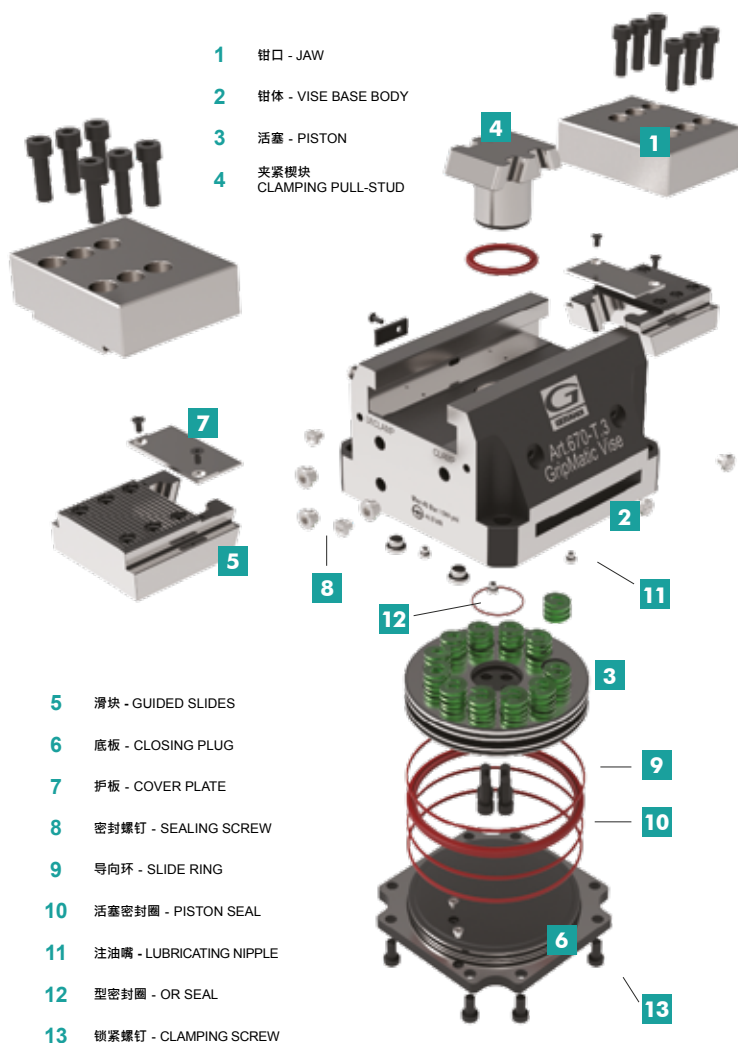

- 1 钳口 - JAW
- 2 钳体 - VISE BASE BODY
- 3 活塞 - PISTON
- 4 夹紧模块
CLAMPING PULL-STUD

- 5 滑块 - GUIDED SLIDES
- 6 底板 - CLOSING PLUG
- 7 护板 - COVER PLATE
- 8 密封螺钉 - SEALING SCREW
- 9 导向环 - SLIDE RING
- 10 活塞密封圈 - PISTON SEAL
- 11 注油嘴 - LUBRICATING NIPPLE
- 12 型密封圈 - OR SEAL
- 13 锁紧螺钉 - CLAMPING SCREW



全自动虎钳

- ✓ 可实现无人化操作
- ✓ 数控化管理
- ✓ 机器人自动装卸工件的理想方案
- ✓ Unattended use possible
- ✓ CNC manageable
- ✓ Ideal for automatic workpiece loading by robot



油/气 直接输入

液压油/压缩空气可从机械主轴直接输入

Compressed air or oil addition directly from the machine table.



多功能性

定位齿结构，种类多样的钳口和液压/气动控制钳口松开实现了此款虎钳的多功能性

Set-up for the quick and safe positioning of the GripMatic vise through Zero Point plate.



Clamping FORCE

	气压	液压
T.2	7 kN	19 kN
T.3	14,4 kN	37,5 kN
T.4	16,9 kN	47 kN