

与所有ER输出兼容 / COMPATIBLE WITH ALL ER OUTPUTS

QUICK CHANGE



ER输出兼容



2年质保



意大利原装



强大的服务 高扭矩
HIGH TORQUE

模块化 高精度
淬火钢

**PRECISION MODULAR STEEL
HRC60 VISES**

- 通用高扭矩模块化快换适配器, 100%意大利制造
- 模块化刀架系统 · 适用于每个从动刀具夹头输出
- 可拆卸的金刚石板和滚珠轴承螺母 · 保证了Gerardi驱动工具的更高刚度和性能
- 所有模块化快换2.0适配器都适用于带外部和内部冷却液供应

- Nuovi cambi rapidi modulari 2.0 a FORTE SERRAGGIO, 100% Made in Italy.
- Sistema di portautensili modulari adatti al montaggio su qualsiasi tipologia di uscita ER.
- Prestazioni garantite e maggior rigidità sui motorizzati Gerardi grazie alla losanga di trascinamento (rimovibile) e alla ghiera con cuscinetto a sfera.
- Adattabili a motorizzati con uscita refrigerante sia interna che esterna.

带外螺纹的内螺母 FOR INTERNAL NUTS WITH EXTERNAL THREAD

内冷却剂 · 可用于壳铣刀

INTERNAL coolant always available, to be specified for SHELL MILL CUTTER

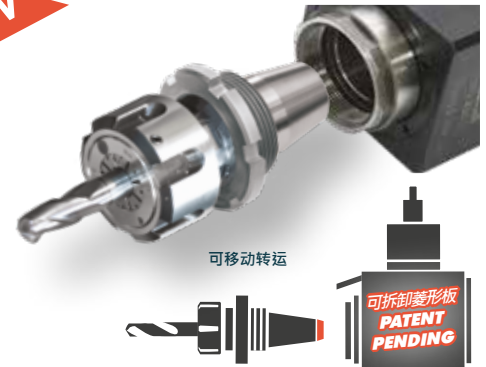

可移动转运



可拆卸菱形板
PATENT
PENDING

Art.182

ART. 182A 型 夹头 - Collet chuck

输入 Input	L (mm)	输出 Output	编码 Code
ER25	29	ER16	9.HT.ER25I.16E
ER25	31	ER20	9.HT.ER25I.20E
ER25	31	ER25	9.HT.ER25I.25E
ER32	29	ER20	9.HT.ER32I.20E
ER32	31	ER25	9.HT.ER32I.25E
ER32	35	ER32	9.HT.ER32I.32E
ER40	31	ER25	9.HT.ER40I.25E
ER40	35	ER32	9.HT.ER40I.32E
ER40	40	ER40	9.HT.ER40I.40E

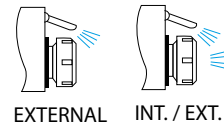

EXTERNAL INT. / EXT.

ART. 182D 型 夹头 - Collet chuck

输入 Input	L (mm)	输出 Output	编码 Code
ER25	9	ER11	9.HT.ER25I.11I
ER25	11	ER16	9.HT.ER25I.16I
ER32	11	ER20	9.HT.ER32I.20I
ER32	11	ER25	9.HT.ER32I.25I
ER40	12	ER25	9.HT.ER40I.25I
ER40	14	ER32	9.HT.ER40I.32I

ART. 182B 型 夹头 壳端铣刀 - Shell end mill cutter*

输入 Input	A	B	输出 Output	编码 Code
	(mm)			
ER25	27	16	Ø16	9.HT.ER25I.P16R
ER25	31	16	Ø22	9.HT.ER25I.P22R
ER32	27	17	Ø16	9.HT.ER32I.P16R
ER32	31	17	Ø22	9.HT.ER32I.P22R
ER40	31	20	Ø22	9.HT.ER40I.P22R
ER40	-	-	Ø27	9.HT.ER40I.P27R
ER50*	-	-	-	-

* A richiesta - On request

上一代驱动工具

ART. 182E 型 夹头 - Collet chuck

输入 Input	L (mm)	输出 Output	编码 Code
ER25	30	ER 11	9.HT.ER25I.11EL
ER25	40	ER 16	9.HT.ER25I.16EL
ER32	40	ER 11	9.HT.ER32I.11EL
ER32	50	ER 16	9.HT.ER32I.16EL
ER32	50	ER 20	9.HT.ER32I.20EL
ER40	50	ER 16	9.HT.ER40I.16EL
ER40	50	ER 20	9.HT.ER40I.20EL
ER40	50	ER 25	9.HT.ER40I.25EL

ART. 182C 型 夹头 - 圆轴夹紧卡盘
Clamping chuck for round shaft (Weldon)

输入 Input	L (mm)	L1 (mm)	Ø		编码 Code
			Ø1	Ø	
ER25	28	36	6	19	9.HT.ER25I.W06
ER25	28	36	8	21	9.HT.ER25I.W08
ER25	29	40	10	28	9.HT.ER25I.W10
ER25	31	45	12	34	9.HT.ER25I.W12
ER25	31	45	14	36	9.HT.ER25I.W14
ER32	28	36	6	19	9.HT.ER32I.W06
ER32	28	36	8	21	9.HT.ER32I.W08
ER32	29	40	10	28	9.HT.ER32I.W10
ER32	31	45	12	34	9.HT.ER32I.W12
ER32	31	45	14	36	9.HT.ER32I.W14
ER32	34	49	16	38	9.HT.ER32I.W16
ER32	34	49	18	40	9.HT.ER32I.W018
ER32	36	51	20	45	9.HT.ER32I.W20
ER40	28	36	6	19	9.HT.ER40I.W06
ER40	28	36	8	21	9.HT.ER40I.W08
ER40	29	40	10	28	9.HT.ER40I.W10
ER40	31	45	12	34	9.HT.ER40I.W12
ER40	31	45	14	36	9.HT.ER40I.W14
ER40	34	49	16	38	9.HT.ER40I.W16
ER40	34	49	18	40	9.HT.ER40I.W18
ER40	36	51	20	45	9.HT.ER40I.W20
ER50*	28	36	6	19	9.HT.ER50I.W06
ER50*	28	36	8	21	9.HT.ER50I.W08
ER50*	29	40	10	28	9.HT.ER50I.W10
ER50*	31	45	12	34	9.HT.ER50I.W12
ER50*	31	45	14	36	9.HT.ER50I.W14
ER50*	34	49	16	38	9.HT.ER50I.W16
ER50*	34	49	18	40	9.HT.ER50I.W18
ER50*	36	51	20	45	9.HT.ER50I.W20
ER50*	36	57	25	51	9.HT.ER50I.W25

* A richiesta - On request

带内螺纹的外螺母 FOR INTERNAL NUTS WITH EXTERNAL THREAD



带内螺纹的外螺母 FOR EXTERNAL NUTS WITH INTERNAL THREAD

内冷却剂 · 可用于壳铣刀

INTERNAL coolant always available, to be specified for SHELL MILL CUTTER

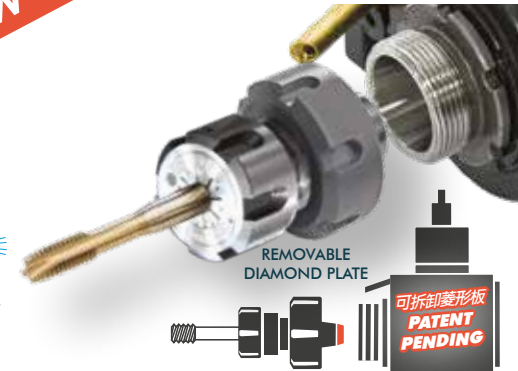

Art.183

ART. 183A型 夹头 - Collet chuck

输入 Input	L (mm)	输出 Output	编码 Code
ER25	29	ER16	9.HT.ER25E.16E
ER25	31	ER20	9.HT.ER25E.20E
ER25	31	ER25	9.HT.ER25E.25E
ER32	29	ER20	9.HT.ER32E.20E
ER32	31	ER25	9.HT.ER32E.25E
ER32	35	ER32	9.HT.ER32E.32E
ER40	31	ER25	9.HT.ER40E.25E
ER40	35	ER32	9.HT.ER40E.32E
ER40	40	ER40	9.HT.ER40E.40E

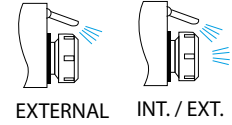

ART. 183D型 夹头 - Collet chuck

输入 Input	L (mm)	输出 Output	编码 Code
ER25	9	ER11	9.HT.ER25E.11I
ER25	11	ER16	9.HT.ER25E.16I
ER32	11	ER20	9.HT.ER32E.20I
ER32	11	ER25	9.HT.ER32E.25I
ER40	12	ER25	9.HT.ER40E.25I
ER40	14	ER32	9.HT.ER40E.32I



ART. 183B型 夹头 壳端铣刀 - Shell end mill cutter

输入 Input	A B (mm)		输出 Output	编码 Code
	A	B		
ER25	27	16	Ø16	9.HT.ER25E.P16R
ER25	31	16	Ø22	9.HT.ER25E.P22R
ER32	27	17	Ø16	9.HT.ER32E.P16R
ER32	31	17	Ø22	9.HT.ER32E.P22R
ER40	31	20	Ø22	9.HT.ER40E.P22R
ER40	-	-	Ø2	9.HT.ER40E.P27R
ER50*	-	-	-	-

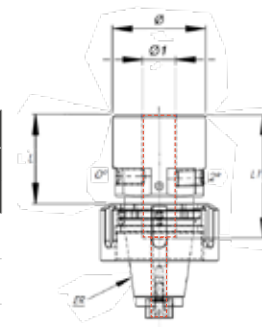
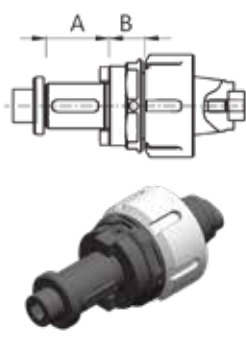

上一代驱动工具

ART. 183E型 夹头 - Collet chuck

输入 Input	L (mm)	输出 Output	编码 Code
ER25	30	ER 11	9.HT.ER25E.11EL
ER25	40	ER 16	9.HT.ER25E.16EL
ER32	40	ER 11	9.HT.ER32E.11EL
ER32	50	ER 16	9.HT.ER32E.16EL
ER32	50	ER 20	9.HT.ER32E.20EL
ER40	50	ER 16	9.HT.ER40E.16EL
ER40	50	ER 20	9.HT.ER40E.20EL
ER40	50	ER 25	9.HT.ER40E.25EL

ART. 183C型 夹头 - 圆轴夹紧卡盘
Clamping chuck for round shaft (Weldon)

输入 Input	L (mm)	L1 (mm)	Ø		编码 Code
			Ø1	Ø	
ER25	28	36	6	19	9.HT.ER25E.W06
ER25	28	36	8	21	9.HT.ER25E.W08
ER25	29	40	10	28	9.HT.ER25E.W10
ER25	31	45	12	34	9.HT.ER25E.W12
ER25	31	45	14	36	9.HT.ER25E.W14
ER32	28	36	6	19	9.HT.ER32E.W06
ER32	28	36	8	21	9.HT.ER32E.W08
ER32	29	40	10	28	9.HT.ER32E.W10
ER32	31	45	12	34	9.HT.ER32E.W12
ER32	31	45	14	36	9.HT.ER32E.W14
ER32	34	49	16	38	9.HT.ER32E.W16
ER32	34	49	18	40	9.HT.ER32E.W018
ER32	36	51	20	45	9.HT.ER32E.W20
ER40	28	36	6	19	9.HT.ER40E.W06
ER40	28	36	8	21	9.HT.ER40E.W08
ER40	29	40	10	28	9.HT.ER40E.W10
ER40	31	45	12	34	9.HT.ER40E.W12
ER40	31	45	14	36	9.HT.ER40E.W14
ER40	34	49	16	38	9.HT.ER40E.W16
ER40	34	49	18	40	9.HT.ER40E.W18
ER40	36	51	20	45	9.HT.ER40E.W20
ER50*	28	36	6	19	9.HT.ER50E.W06
ER50*	28	36	8	21	9.HT.ER50E.W08
ER50*	29	40	10	28	9.HT.ER50E.W10
ER50*	31	45	12	34	9.HT.ER50E.W12
ER50*	31	45	14	36	9.HT.ER50E.W14
ER50*	34	49	16	38	9.HT.ER50E.W16
ER50*	34	49	18	40	9.HT.ER50E.W18
ER50*	36	51	20	45	9.HT.ER50E.W20
ER50*	36	57	25	51	9.HT.ER50E.W25

* A richiesta - On request

* A richiesta - On request



带内螺纹的外螺母 FOR EXTERNAL NUTS WITH INTERNAL THREAD

带外螺纹的内螺母

FOR INTERNAL NUTS WITH EXTERNAL THREAD

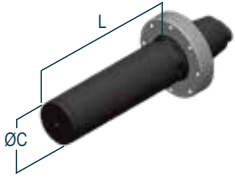

Art. 182K	主控制销 Master control pin		
输入 Input	L (mm)	输出 Output	编码 Code
ER25	95	Ø25	9.HT.ER25I.95MC
ER32	105	Ø30	9.HT.ER32I.105MC
ER40	105	Ø30	9.HT.ER40I.105MC
ER50	105	Ø30	9.HT.ER50I.105MC



Art. 182M	预设主适配器 Preset master adapter		
输入 Input	L (mm)	输出 Output	编码 Code
ER25	25	Ø25	9.HT.ER25I.25MP
ER32	35	Ø30	9.HT.ER32I.30MP
ER40	45	Ø30	9.HT.ER40I.30MP
ER50	55	Ø30	9.HT.ER50I.30MP



Art. 182Q	型-快速更换安装装置 Quick change mounting device		
输入 Input	L (mm)	输出 Output	编码 Code
Ø88	-	ER25	9.HT.ER25IP
Ø98	-	ER32	9.HT.ER32IP
Ø108	-	ER40	9.HT.ER40IP
Ø118	-	ER50	9.HT.ER50IP

PER PORTAUTENSILI STATICI
FOR STATIC TOOL

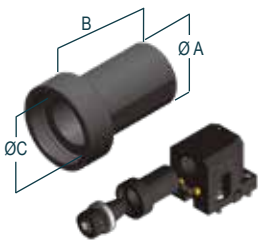

Art. 182S	QCA用圆柱形柄座 Cylindrical shank holder for QCA		
输入 Input	B (mm)	输出 Output	编码 Code
Ø25	45	ER25	9.HT.B25.ER25I
Ø30	55	ER25	9.HT.B30.ER25I
Ø32	55	ER25	9.HT.B32.ER25I
Ø40	70	ER 32	9.HT.B40.ER32I
Ø50	80	ER 40	9.HT.B50.ER40I

带内螺纹的外螺母

FOR EXTERNAL NUTS WITH INTERNAL THREAD

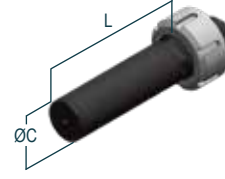

Art. 182L	主控制销 Master control pin		
输入 Input	L (mm)	输出 Output	编码 Code
ER25	95	Ø20	9.HT.ER25E.95MC
ER32	105	Ø30	9.HT.ER32E.105MC
ER40	105	Ø30	9.HT.ER40E.105MC
ER50	105	Ø30	9.HT.ER50E.105MC



Art. 183N	预设主适配器 Preset master adapter		
输入 Input	L (mm)	输出 Output	编码 Code
ER25	93	Ø25	9.HT.ER25E.25MP
ER32	105	Ø30	9.HT.ER32E.30MP
ER40	105	Ø30	9.HT.ER40E.30MP
ER50	105	Ø30	9.HT.ER50E.30MP



Art. 183P	型-快速更换安装装置 Quick change mounting device		
输入 Input	L (mm)	输出 Output	编码 Code
Ø65	37	ER25	9.HT.ER25.EP
Ø75	42	ER32	9.HT.ER32.EP
Ø85	47	ER40	9.HT.ER40.EP
Ø98	57	ER50	9.HT.ER50.EP

Art. 183R*	ER空白 ER blank		
输入 Input	L (mm)	输出 Output	编码 Code
ER25	70	Ø40	9.HT.ER25.E70
ER32	75	Ø48	9.HT.ER32.E75
ER40	90	Ø60	9.HT.ER40.E90
ER50	90	Ø75	9.HT.ER50.E90

* 也可用于带外螺纹的内螺母 (182T) (ART.182T)

* Also Available for INTERNAL nuts with EXTERNAL thread (ART.182T)

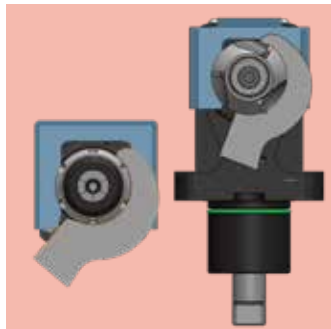

易于拆卸!
Easy to remove!

新的螺母和工具锁定系统带单手扳手
-
New NUT&TOOLS locking system with one-hand wrench.



实惠省钱
Money saver

通过使用通用快换适配器，可以降低进一步主轴单元的成本。
-
The costs for further requirements of spindle units can be reduced by using the universal quick change adaptors



多功能性和性能得到改善
Versatility & performance improved

输出范围广泛。
最高刚性的滚珠轴承螺母和金刚石板。
-
Wide range of outputs available. Ball bearing nut and diamond plate for highest rigidity.



极端兼容性
Extreme compatibility

快速转换适配器可以安装在任何类型的驱动工具或带有ER输出的直角头上。
-
The quick change adaptors can be mounted on any type of Driven Tool or right Angle Head with ER output