

Turret Series:

■ VDI - DIN 5480

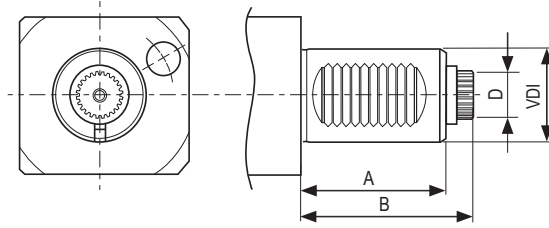

VDI	A	B	D
20	35	51	10,8
25	48	57	13,8
30	55	67	15,8
40	63	75	19,8
50	78	93	23,8



AX
Assiale - Axial



RD
Radiale - Radial



Off AX
Disassato - Off-set axis



RO
Arretrato - Rear Off-set



2U
Radiale 2 uscite
Radial 2 outputs



UN
Regolabile ± 90° - Adjustable



Code	Orient	VDI	Rotation	Output	Int. Cool.	Nm	Rpm	H
99.ST.8001	AX	20	▼	ER-20	-	13	6000	60
99.ST.8002	AX	25	▼	ER-20	-	20	6000	60
99.ST.8003	AX	30	▼	ER-25	-	32	5000	66
99.ST.8004	AX	30	▼	ER-25	-	32	5000	94
99.ST.8005	AX	40	▼	ER-32	-	63	4000	95
99.ST.8006	AX	40	▼	ER-32	-	63	4000	115
99.ST.8007	AX	50	▼	ER-40	-	100	4000	88
99.ST.8008	AX	50	▼	ER-40	-	100	4000	120
99.ST.8009	AX	20	▼	ER-20	● 25bar	13	6000	89
99.ST.8010	AX	25	▼	ER-20	● 25bar	20	6000	89
99.ST.8011	AX	30	▼	ER-25	● 25bar	32	5000	66
99.ST.8012	AX	30	▼	ER-25	● 25bar	32	5000	94
99.ST.8013	AX	40	▼	ER-32	● 25bar	63	4000	95
99.ST.8014	AX	40	▼	ER-32	● 25bar	63	4000	115
99.ST.8015	AX	50	▼	ER-40	● 25bar	100	4000	120
99.ST.8016	AX	50	▼	ER-40	● 25bar	100	4000	155
99.ST.8017	AX	20	▼	ER-16	-	3,5	24.000 (1:4)	98,5
99.ST.8018	AX	25	▼	ER-16	-	5	24.000 (1:4)	98,5
99.ST.8019	AX	30	▼	ER-16	-	8	20.000 (1:4)	100
99.ST.8020	AX	40	▼	ER-20	-	16	16.000 (1:4)	112,5
99.ST.8021	AX	50	▼	ER-20	-	25	16.000 (1:4)	128,5
99.ST.8022	AX	20	▼	PF-Ø16	-	13	6000	110,5
99.ST.8023	AX	25	▼	PF-Ø16	-	20	6000	110,5
99.ST.8024	AX	30	▼	PF-Ø22	-	32	5000	112

Code	Orient	VDI	Rotation	Output	Int. Cool.	Nm	Rpm	H
99.ST.8025	AX	40	▼	PF-Ø22	-	13	4000	102
99.ST.8026	AX	50	▼	PF-Ø22	-	20	4000	138
99.ST.8027	AX	50	▼	PF-Ø27	-	32	4000	138
99.ST.8028	RD	20	▼	ER-20	-	13	6000	75
99.ST.8029	RD	25	▼	ER-20	-	20	6000	75
99.ST.8030	RD	30	▼	ER-25	-	32	5000	55
99.ST.8031	RD	30	▼	ER-25	-	32	5000	85
99.ST.8032	RD	30	▼	ER-25	-	32	5000	100
99.ST.8033	RD	40	▼	ER-32	-	63	4000	100
99.ST.8034	RD	40	▼	ER-32	-	63	4000	120
99.ST.8035	RD	50	▼	ER-40	-	100	4000	110
99.ST.8036	RD	20	▼	ER-20	● 25bar	13	6000	75
99.ST.8037	RD	25	▼	ER-20	● 25bar	20	6000	75
99.ST.8038	RD	30	▼	ER-25	● 25bar	32	5000	55
99.ST.8039	RD	30	▼	ER-25	● 25bar	32	5000	85
99.ST.8040	RD	30	▼	ER-25	● 25bar	32	5000	100
99.ST.8041	RD	40	▼	ER-32	● 25bar	63	4000	100
99.ST.8042	RD	40	▼	ER-32	● 25bar	63	4000	120
99.ST.8043	RD	50	▼	ER-40	● 25bar	100	4000	110
99.ST.8044	RO	20	▼	ER-20	-	13	6000	75
99.ST.8045	RO	25	▼	ER-20	-	20	6000	75
99.ST.8046	RO	30	▼	ER-25	-	32	5000	85
99.ST.8047	RO	30	▼	ER-25	-	32	5000	100
99.ST.8048	RO	40	▼	ER-32	-	63	4000	100



Code	Orient	VDI	Rotation	Output	Int Cool.	Nm	Rpm	H
99.ST.8049	RO	50	▼	ER-40	-	100	4000	110
99.ST.8050	RO	20	▼	ER-20	● 25bar	13	6000	75
99.ST.8051	RO	25	▼	ER-20	● 25bar	20	6000	75
99.ST.8052	RO	30	▼	ER-25	● 25bar	32	5000	85
99.ST.8053	RO	30	▼	ER-25	● 25bar	32	5000	100
99.ST.8054	RO	40	▼	ER-32	● 25bar	63	4000	100
99.ST.8055	RO	50	▼	ER-40	● 25bar	100	4000	110
99.ST.8056	RO	20	▼	ER-16	-	3,5	24.000 (1:4)	90
99.ST.8057	RO	25	▼	ER-16	-	5	24.000 (1:4)	90
99.ST.8058	RO	30	▼	ER-16	-	8	21.000 (1:4)	95
99.ST.8059	RO	40	▼	ER-20	-	16	16.000 (1:4)	125
99.ST.8060	RO	50	▼	ER-20	-	25	16.000 (1:4)	135
99.ST.8061	RD	20	▼	ER-20	-	26	3000 (2:1)	75
99.ST.8062	RD	25	▼	ER-20	-	40	3000 (2:1)	75
99.ST.8063	RD	30	▼	ER-25	-	63	2500 (2:1)	55
99.ST.8064	RD	30	▼	ER-25	-	63	2500 (2:1)	85
99.ST.8065	RD	30	▼	ER-25	-	63	2500 (2:1)	100
99.ST.8066	RD	40	▼	ER-32	-	63	2000 (2:1)	100
99.ST.8067	RD	40	▼	ER-32	-	63	2000 (2:1)	120
99.ST.8068	RD	50	▼	ER-40	-	100	2000 (2:1)	110
99.ST.8069	RD	20	▼	PF-Ø16	-	26	3000 (2:1)	75

Code	Orient	VDI	Rotation	Output	Int. Cool.	Nm	Rpm	H
99.ST.8070	RD	25	▼	PF-Ø16	-	40	3000 (2:1)	75
99.ST.8071	RD	30	▼	PF-Ø22	-	63	2500 (2:1)	55
99.ST.8072	RD	30	▼	PF-Ø22	-	63	2500 (2:1)	85
99.ST.8073	RD	30	▼	PF-Ø22	-	63	2500 (2:1)	100
99.ST.8074	RD	40	▼	PF-Ø22	-	63	2000 (2:1)	100
99.ST.8075	RD	40	▼	PF-Ø22	-	63	2000 (2:1)	120
99.ST.8076	RD	50	▼	PF-Ø27	-	100	2000 (2:1)	110
99.ST.8077	2U	20	▼	ER-20-20	-	13	6000	75
99.ST.8078	2U	25	▼	ER-20-20	-	20	6000	75
99.ST.8079	2U	30	▼	ER-25-25	-	32	5000	85
99.ST.8080	2U	30	▼	ER-25-25	-	32	5000	100
99.ST.8081	2U	40	▼	ER-32-32	-	63	4000	100
99.ST.8082	2U	40	▼	ER-32-32	-	63	4000	120
99.ST.8087	UN ±90°	30	▼	ER-30	● 25bar	15	5000	64
99.ST.8088	UN ±90°	30	▼	ER-20	● 25bar	15	5000	55
99.ST.8089	UN ±90°	40	▼	ER-25	● 25bar	25	4000	63
99.ST.8090	UN ±90°	50	▼	ER-40	● 25bar	50	4000	78
99.ST.8091	UN ±90°	30	▼	ER-20	● 25bar	15	5000	64
99.ST.8092	UN ±90°	30	▼	ER-20	● 25bar	15	5000	97
99.ST.8093	UN ±90°	40	▼	ER-25	● 25bar	25	4000	81

- ▼ Direction of rotation opposite of machine spindle
- ▼ Direction of rotation same as machine spindle
- Internal Coolant

Turret series:
■ VDI - DIN 5480

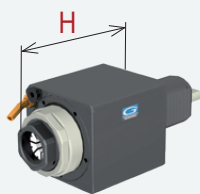

AX
Assiale - Axial

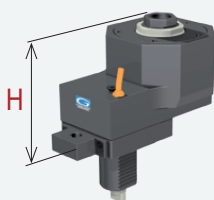

Off-AX
Assiale disassato - Off-set axis

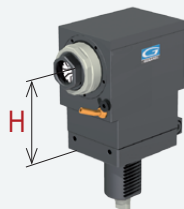

RD
Radiale - Radial

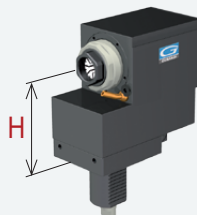

RO
Arretrato - Rear Off-set

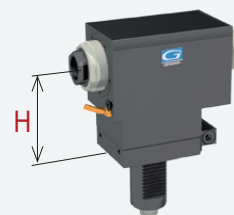

2U
Doppia uscita - Double output



UN
Regolabile ±90° - Adjustable

Turret Series:

■ VDI - DIN 5482

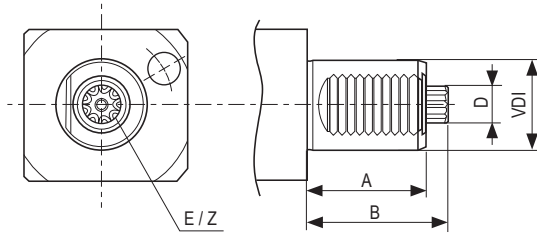

VDI	A	B	D
30	45	55	14,5
40	53	63	16,5
50	78	93	19,5
60	94	108	24,5



AX
Assiale - Axial



RD
Radiale - Radial



Off-AX
Disassato- Off-set axis



RO
Arretrato - Rear Off-set



UN
Regolabile ±90° - Adjustable



Code	Orient	VDI	Rotation	Output	Int. Cool.	Nm	Rpm	H
99.ST.8201	AX	30	▼	ER-25	-	32	5000	94
99.ST.8202	AX	30	▼	ER-25	-	32	5000	66
99.ST.8203	AX	40	▼	ER-32	-	63	4000	115
99.ST.8204	AX	40	▼	ER-32	-	63	4000	95
99.ST.8205	AX	50	▼	ER-40	-	100	4000	150
99.ST.8206	AX	60	▼	ER-50	-	160	3200	220
99.ST.8207	AX	30	▼	ER-25	● 25bar	32	5000	91
99.ST.8208	AX	40	▼	ER-32	● 25bar	63	4000	115
99.ST.8209	AX	40	▼	ER-32	● 25bar	63	4000	95
99.ST.8210	AX	50	▼	ER-40	● 25bar	100	4000	133
99.ST.8211	AX	60	▼	ER-50	● 25bar	160	3200	228
99.ST.8212	AX	30	▼	ER-16	-	8	20000	100
99.ST.8213	AX	40	▼	ER-20	-	16	16000	112,5
99.ST.8214	AX	50	▼	ER-20	-	25	16000	128,5
99.ST.8215	AX	30	▼	PF-Ø22	-	32	5000	112
99.ST.8216	AX	40	▼	PF-Ø22	-	63	4000	124
99.ST.8217	RD	30	▼	ER-25	-	32	5000	55
99.ST.8218	RD	30	▼	ER-25	-	32	5000	85
99.ST.8219	RD	30	▼	ER-25	-	32	5000	100

Code	Orient	VDI	Rotation	Output	Int. Cool.	Nm	Rpm	H
99.ST.8220	RD	40	▼	ER-32	-	63	4000	100
99.ST.8221	RD	50	▼	ER-40	-	100	4000	110
99.ST.8222	RD	60	▼	ER-50	-	160	3200	130
99.ST.8223	RD	30	▼	ER-25	● 25bar	32	5000	55
99.ST.8224	RD	30	▼	ER-25	● 25bar	32	5000	85
99.ST.8225	RD	30	▼	ER-25	● 25bar	32	5000	100
99.ST.8226	RD	40	▼	ER-32	● 25bar	63	4000	100
99.ST.8227	RD	50	▼	ER-40	● 25bar	100	4000	110
99.ST.8228	RD	60	▼	ER-50	● 25bar	160	3200	130
99.ST.8229	RO	30	▼	ER-25	-	32	5000	85
99.ST.8230	RO	40	▼	ER-32	-	63	4000	100
99.ST.8231	RO	50	▼	ER-40	-	100	4000	110
99.ST.8232	RO	60	▼	ER-50	-	160	3200	135
99.ST.8233	RO	30	▼	ER-25	● 25bar	32	5000	85
99.ST.8234	RO	40	▼	ER-32	● 25bar	63	4000	100
99.ST.8235	RO	50	▼	ER-40	● 25bar	100	4000	110
99.ST.8236	RO	60	▼	ER-50	● 25bar	160	3200	135
99.ST.8237	RO	30	▼	ER-16	-	8	20000 (1:4)	95
99.ST.8238	RO	40	▼	ER-20	-	16	16000 (1:4)	125



Code	Orient	VDI	Rotation	Output	Int Cool.	Nm	Rpm	H
99.ST.8239	RO	50	▼	ER-20	-	25	16000 (1:4)	135
99.ST.8240	RD	30	▼	ER-25	-	63	2500	55
99.ST.8241	RD	40	▼	ER-32	-	63	2000 (2:1)	100
99.ST.8242	RD	30	▼	PF-Ø22	-	63	2500 (2:1)	55
99.ST.8243	RD	40	▼	PF-Ø22	-	63	2000	100
99.ST.8244	RO	30	▼	PF-Ø22	-	32	2500	85
99.ST.8245	RO	40	▼	PF-Ø22	-	63	4000	100
99.ST.8246	Off-AX	30	▼	ER-25	-	64	3000 (2:1)	95
99.ST.8247	Off-AX	30	▼	PF-Ø22	● 25bar	64	3000 (2:1)	95
99.ST.8248	UN ±90°	30	▼	ER-20	-	15	5000	64
99.ST.8249	UN ±90°	30	▼	ER-20	-	15	5000	97
99.ST.8250	UN ±90°	40	▼	ER-25	-	25	4000	81
99.ST.8251	UN ±90°	50	▼	ER-40	-	50	4000	123
99.ST.8252	UN ±90°	60	▼	ER-40	-	50	4000	123
99.ST.8253	UN ±90°	30	▼	ER-20	● 25bar	15	5000	64
99.ST.8254	UN ±90°	30	▼	ER-20	● 25bar	15	5000	97
99.ST.8255	UN ±90°	40	▼	ER-25	● 25bar	25	4000	81

▼ Direction of rotation opposite of machine spindle

▼ Direction of rotation same as machine spindle

● Internal Coolant

Turret series:

■ VDI - DIN 5482

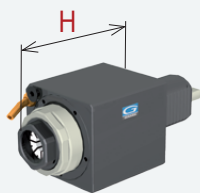

AX
Assiale - Axial

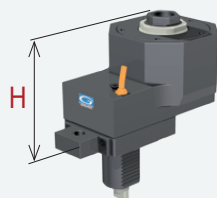

Off-AX
Assiale disassato - Off-set axis

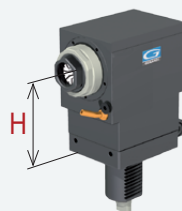

RD
Radiale - Radial

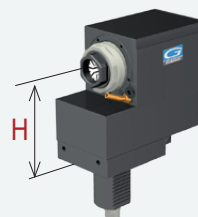

RO
Arretrato - Rear Off-set

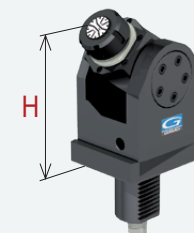

UN
Regolabile ±90° - Adjustable

Turret Series:

■ VDI - BARUFFALDI

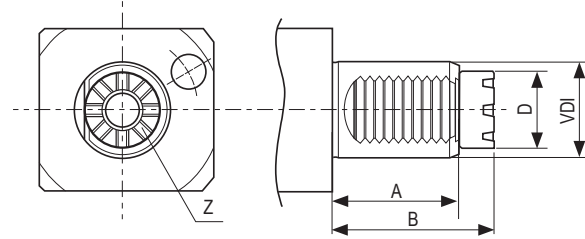
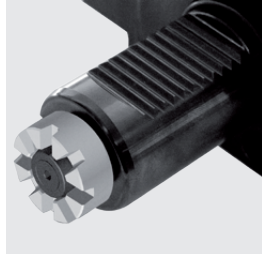

VDI	A	B	D
20	35	41	19
30	45/53	59	24
40	53	68	32
50	70	84	40
60	83	100	43



AX
Assiale - Axial



RD
Radiale - Radial



Off AX
Disassato - Off-set axis



RO
Arretrato - Rear Off-set



2U
Radiale 2 uscite
Radial 2 outputs



UN
Regolabile ± 90° - Adjustable



Code	Orient	VDI	Rotation	Output	Int. Cool.	Nm	Rpm	H
99.BF.0001	AX	20	▼	ER-20	-	13	6000	90
99.BF.0002	AX	20	▼	ER-20	-	13	6000	65
99.BF.0003	AX	30	▼	ER-30	-	32	6000	94
99.BF.0004	AX	30	▼	ER-30	-	32	5000	66
99.BF.0005	AX	40	▼	ER-40	-	63	4000	117
99.BF.0006	AX	40	▼	ER-40	-	63	4000	95
99.BF.0007	AX	50	▼	ER-50	-	100	4000	120
99.BF.0008	AX	50	▼	ER-50	-	100	4000	88
99.BF.0009	AX	60	▼	ER-60	-	160	3200	170
99.BF.0010	AX	30	▼	ER-25	● 25bar	32	5000	94
99.BF.0011	AX	40	▼	ER-32	● 25bar	63	4000	115
99.BF.0012	AX	40	▼	ER-40	● 25bar	63	4000	95
99.BF.0013	AX	50	▼	ER-50	● 25bar	100	4000	120
99.BF.0014	AX	60	▼	ER-60	● 25bar	160	3200	170
99.BF.0015	AX	20	▼	ER-16	-	3	24.000 (1:4)	100
99.BF.0016	AX	30	▼	ER-16	-	8	20.000 (1:4)	100
99.BF.0017	AX	40	▼	ER-20	-	16	16.000 (1:4)	112,5
99.BF.0018	AX	30	▼	PF-Ø22	-	32	5000	112
99.BF.0019	AX	40	▼	PF-Ø22	-	63	4000	124
99.BF.0020	RD	20	▼	ER-20	-	13	6000	60
99.BF.0021	RD	30	▼	ER-25	-	32	6000	55
99.BF.0022	RD	30	▼	ER-25	-	32	5000	85
99.BF.0023	RD	30	▼	ER-25	-	32	5000	100
99.BF.0024	RD	40	▼	ER-32	-	63	4000	100

Code	Orient	VDI	Rotation	Output	Int. Cool.	Nm	Rpm	H
99.BF.0025	RD	50	▼	ER-40	-	100	4000	110
99.BF.0026	RD	60	▼	ER-50	-	160	3200	130
99.BF.0027	RD	30	▼	ER-25	● 25bar	32	5000	55
99.BF.0028	RD	30	▼	ER-25	● 25bar	32	5000	85
99.BF.0029	RD	30	▼	ER-25	● 25bar	32	5000	100
99.BF.0030	RD	40	▼	ER-32	● 25bar	63	4000	100
99.BF.0031	RD	50	▼	ER-40	● 25bar	100	4000	110
99.BF.0032	RD	60	▼	ER-50	● 25bar	160	3200	130
99.BF.0033	RO	20	▼	ER-16	-	13	6000	75
99.BF.0034	RO	30	▼	ER-25	-	32	5000	85
99.BF.0035	RO	40	▼	ER-32	-	63	4000	100
99.BF.0036	RO	50	▼	ER-40	-	100	4000	110
99.BF.0037	RO	30	▼	ER-25	● 25bar	32	5000	85
99.BF.0038	RO	40	▼	ER-32	● 25bar	63	4000	100
99.BF.0039	RO	50	▼	ER-40	● 25bar	100	4000	110
99.BF.0040	RO	20	▼	ER-16	-	3	24000 (1:4)	75
99.BF.0041	RO	30	▼	ER-16	-	8	20000 (1:4)	95
99.BF.0042	RO	40	▼	ER-20	-	16	16000 (1:4)	125
99.BF.0043	RD	30	▼	ER-25	-	63	2500	55
99.BF.0044	RD	40	▼	ER-32	-	63	2000	100
99.BF.0045	RO	30	▼	PF-Ø22	-	63	2500	55
99.BF.0046	RO	40	▼	PF-Ø22	-	63	2000	100
99.BF.0047	RO	30	▼	PF-Ø22	-	32	5000	85
99.BF.0048	RO	40	▼	PF-Ø22	-	63	4000	100

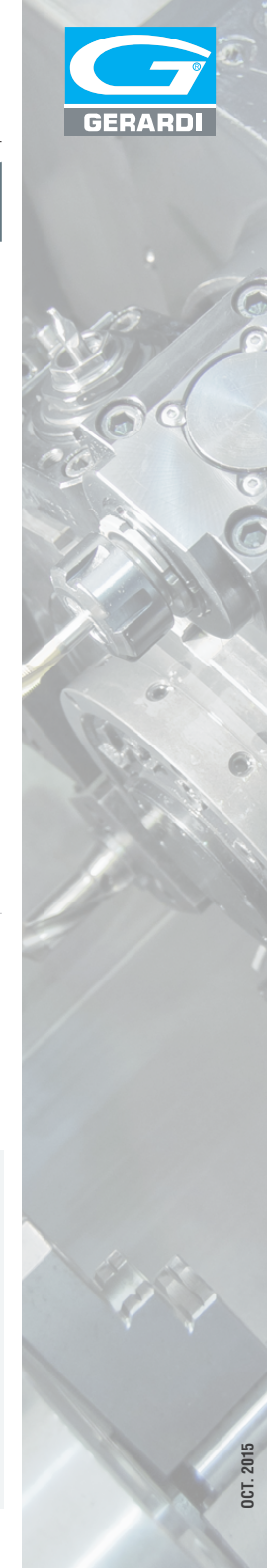

Code	Orient	VDI	Rotation	Output	Int Cool.	Nm	Rpm	H
99.BF.0049	Off-AX	30	▼	ER-25	-	64	3000	95
99.BF.0050	Off-AX	30	▼	PF-Ø22	-	64	3000	95
99.BF.0051	UN ±90°	30	▼	ER-20	-	15	5000	64
99.BF.0052	UN ±90°	30	▼	ER-30	-	15	5000	97
99.BF.0053	UN ±90°	40	▼	ER-40	-	25	4000	81
99.BF.0054	UN ±90°	30	▼	ER-30	● 25bar	15	5000	64
99.BF.0055	UN ±90°	30	▼	ER-30	● 25bar	15	5000	97
99.BF.0056	UN ±90°	40	▼	ER-40	● 25bar	25	4000	81
99.BF.0057	RD	30	▼	ER-25	-	32	5000	55
99.BF.0058	RD	30	▼	ER-25	-	32	5000	85

Code	Orient	VDI	Rotation	Output	Int Cool.	Nm	Rpm	H
99.BF.0059	RD	30	▼	ER-25	-	32	5000	100
99.BF.0060	RD	50	▼	ER-40	-	100	4000	110
99.BF.0061	RD	30	▼	ER-25	● 25bar	32	5000	55
99.BF.0062	RD	30	▼	ER-25	● 25bar	32	5000	85
99.BF.0063	RD	30	▼	ER-25	● 25bar	32	5000	100
99.BF.0064	RD	50	▼	ER-40	● 25bar	100	4000	110
99.BF.0065	Off AX	30	▼	ER-25	-	64	3000 (2:1)	95
99.BF.0066	Off AX	30	▼	PF Ø22	-	64	3000 (2:1)	95
99.BF.0067	2U	30	▼	ER-25	-	32	5000	110
99.BF.0068	2U	30	▼	ER-40	-	100	4000	140

- ▼ Direction of rotation opposite of machine spindle
- ▲ Direction of rotation same as machine spindle
- Internal Coolant

Turret series:

■ VDI - BARUFFALDI

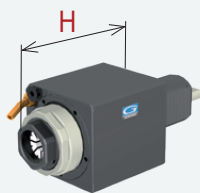

AX
Assiale - Axial

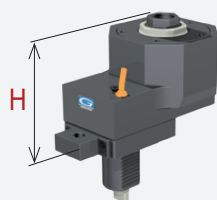

Off-AX
Assiale disassato - Off-set axis

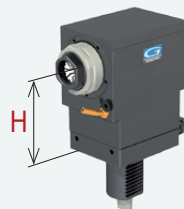

RD
Radiale - Radial

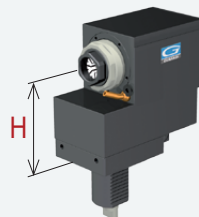

RO
Arretrato - Rear Off-set

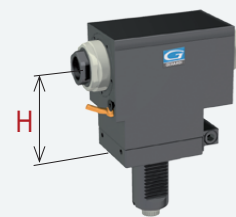

2U
Doppia uscita - Double output



UN
Regolabile ±90° - Adjustable

Turret Series:

■ VDI - DIN 1809

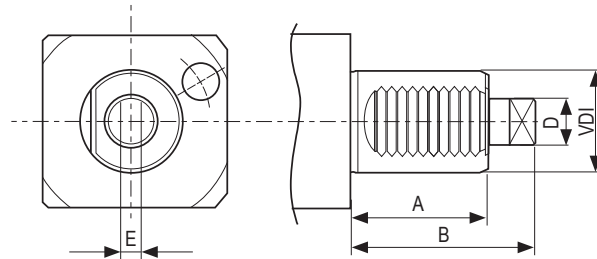

VDI	A	B	D	E
20	35	48	10	5
30	45	62	12	6
40	53	72	18	8
50	78	92	24	13
60	83	110	29	14



AX
Assiale - Axial



RD
Radiale - Radial



Off-AX
Disassato- Off-set axis



RO
Arretrato - Rear Off-set



UN
Regolabile $\pm 90^\circ$ - Adjustable



Code	Orient	VDI	Rotation	Output	Int. Cool.	Nm	Rpm	H
99.DP.0901	AX	20	▼	ER-20	-	13	6000	65
99.DP.0902	AX	20	▼	ER-20	-	13	6000	90
99.DP.0903	AX	30	▼	ER-25	-	32	5000	94
99.DP.0904	AX	30	▼	ER-25	-	32	5000	66
99.DP.0905	AX	40	▼	ER-32	-	63	4000	115
99.DP.0906	AX	40	▼	ER-32	-	63	4000	95
99.DP.0907	AX	50	▼	ER-40	-	100	4000	120
99.DP.0908	AX	50	▼	ER-40	-	100	4000	88
99.DP.0909	AX	60	▼	ER-50	-	160	3200	170
99.DP.0910	AX	30	▼	ER-25	● 25bar	32	5000	94
99.DP.0911	AX	40	▼	ER-32	● 25bar	63	4000	115
99.DP.0912	AX	40	▼	ER-32	● 25bar	63	4000	95
99.DP.0913	AX	50	▼	ER-40	● 25bar	100	4000	120
99.DP.0914	AX	60	▼	ER-50	● 25bar	160	3200	170
99.DP.0915	AX	20	▼	ER-16	-	3	24.000 (1:4)	100
99.DP.0916	AX	30	▼	ER-16	-	8	20.000 (1:4)	100

Code	Orient	VDI	Rotation	Output	Int. Cool.	Nm	Rpm	H
99.DP.0917	RO	20	▼	ER-16	-	3	24.000 (1:4)	75
99.DP.0918	RD	20	▼	ER-20	-	13	6000	60
99.DP.0919	RD	30	▼	ER-25	-	32	5000	55
99.DP.0920	RD	30	▼	ER-25	-	32	5000	85
99.DP.0921	RD	30	▼	ER-25	-	32	5000	100
99.DP.0922	RD	40	▼	ER-32	-	63	4000	100
99.DP.0923	RD	50	▼	ER-40	-	100	4000	110
99.DP.0924	RD	60	▼	ER-50	-	160	3200	130
99.DP.0925	RD	30	▼	ER-25	● 25bar	32	5000	55
99.DP.0926	RD	30	▼	ER-25	● 25bar	32	5000	85
99.DP.0927	RD	30	▼	ER-25	● 25bar	32	5000	100
99.DP.0928	RD	40	▼	ER-32	● 25bar	63	4000	100
99.DP.0929	RD	50	▼	ER-40	● 25bar	100	4000	110
99.DP.0930	RD	60	▼	ER-50	● 25bar	160	3200	130
99.DP.0931	RO	20	▼	ER-16	-	13	6000	75
99.DP.0932	RO	30	▼	ER-25	-	32	5000	85

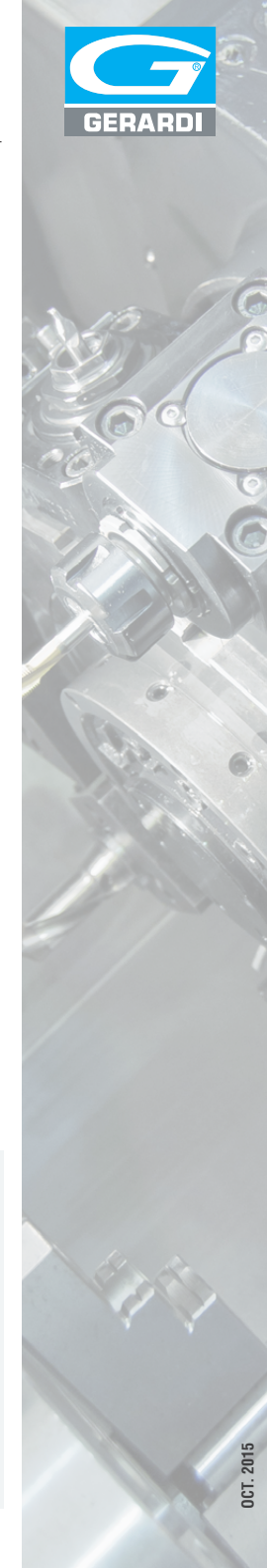

Code	Orient	VDI	Rotation	Output	Int. Coolant	Nm	Rpm	H
99.DP.0933	RO	40	▼	ER-32	-	63	4000	100
99.DP.0934	RO	50	▼	ER-40	-	100	4000	110
99.DP.0935	RO	30	▼	ER-25	● 25bar	32	5000	85
99.DP.0936	RO	40	▼	ER-32	● 25bar	63	4000	100
99.DP.0937	RO	50	▼	ER-40	● 25bar	100	4000	110
99.DP.0938	Off-AX	30	▼	ER-25	-	64	3000 (2:1)	95
99.DP.0939	Off-AX	30	▼	PF-22	● 25bar	64	3000 (2:1)	95
99.DP.0940	UN	30	▼	ER-20	-	15	5000	64
99.DP.0941	UN	30	▼	ER-20	-	15	5000	97
99.DP.0942	UN	40	▼	ER-25	-	25	4000	81
99.DP.0943	UN	30	▼	ER-20	● 25bar	15	5000	64
99.DP.0944	UN	30	▼	ER-20	● 25bar	15	5000	97
99.DP.0945	UN	40	▼	ER-25	● 25bar	25	4000	81

▼ Direction of rotation opposite of machine spindle

▼ Direction of rotation same as machine spindle

● Internal Coolant

Turret series:

■ VDI - DIN 1809

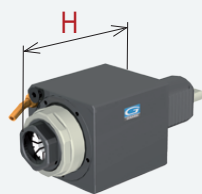

AX
Assiale - Axial

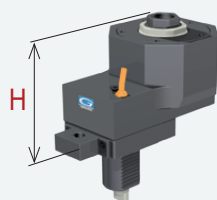

Off-AX
Assiale disassato - Off-set axis

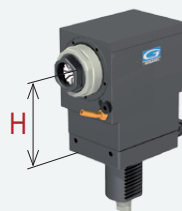

RD
Radiale - Radial

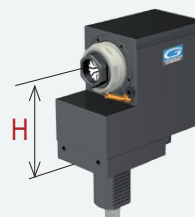

RO
Arretrato - Rear Off-set



UN
Regolabile ±90° - Adjustable